

T-Rex 700

Pre-Production

Manual

700NH1A

Apply a little amount of T43 thread lock when fixing a metal part.
螺絲鎖附於金屬件請使用適量T43(螺絲膠)

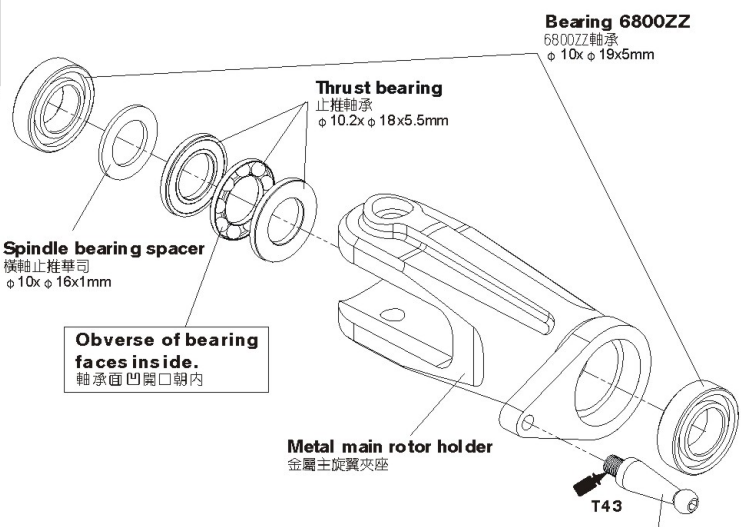
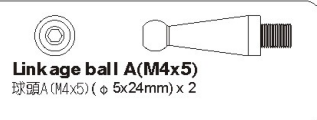
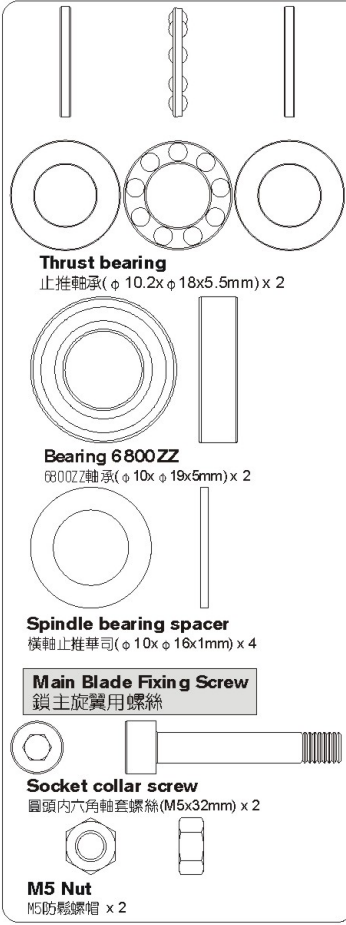

CAUTION 注意

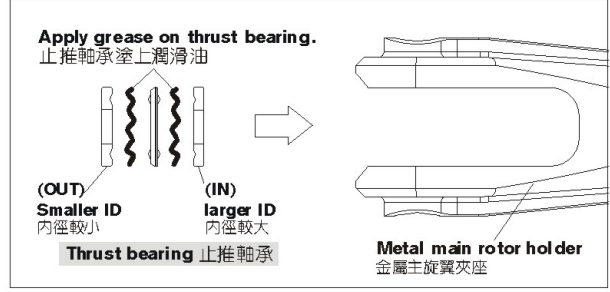

CAUTION 注意

Already assembled by Factory.
Before flying, please check if the screws are fixed with glue.
原裝組裝完成品，每一次飛行前請先確認螺絲是否已上膠不會鬆動。

700NH2

Apply a little amount of T43 thread lock when fixing a metal part.
螺絲鎖附於金屬件請使用適量T43(螺絲膠)

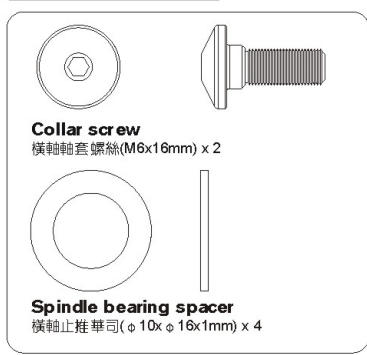

700NH2A

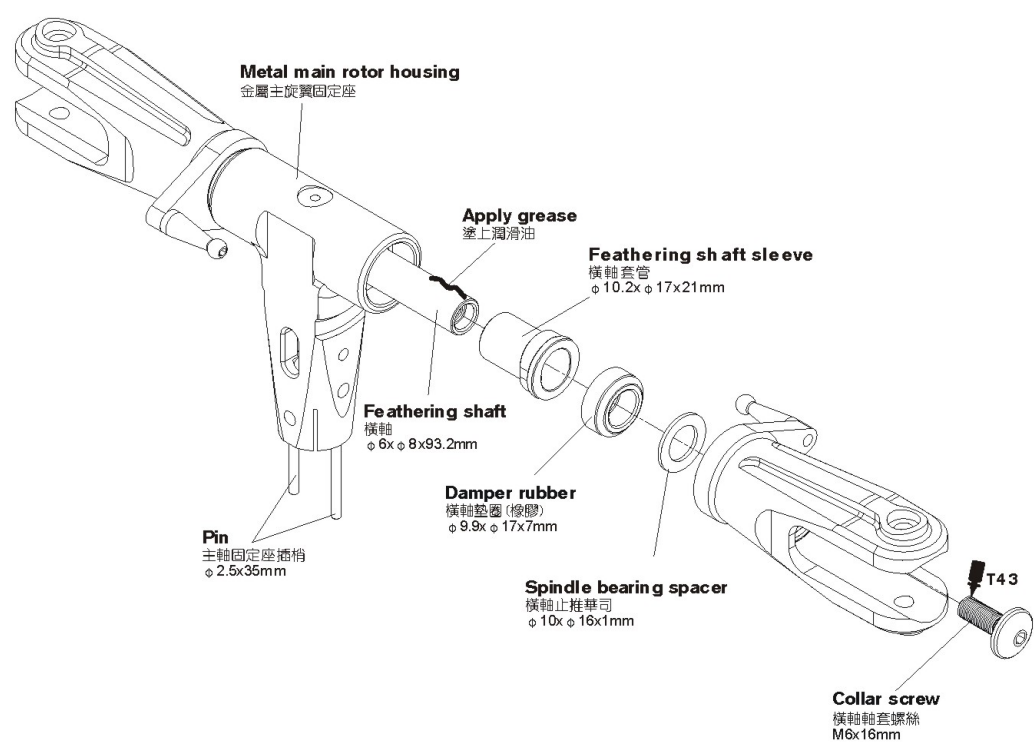
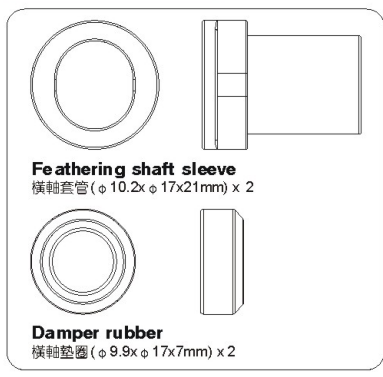

700NH2

Bearing MR104ZZ
MR104ZZ軸承(φ4xφ10x4mm) x 2

Bearing 683ZZ
683ZZ軸承(φ3xφ7x3mm) x 4

Bearing F105ZZ
F105ZZ軸承(φ5xφ11.2xφ10x4mm) x 2

Collar
擺臂軸承襯套(φ3xφ4.8x1.5mm) x 2

Linkage ball B(M3x4)
球頭B(M3x4)(φ5x12mm) x 4

Apply a little amount of T43 thread lock when fixing a metal part.
螺絲鎖附於金屬件請使用適量T43(螺絲膠)

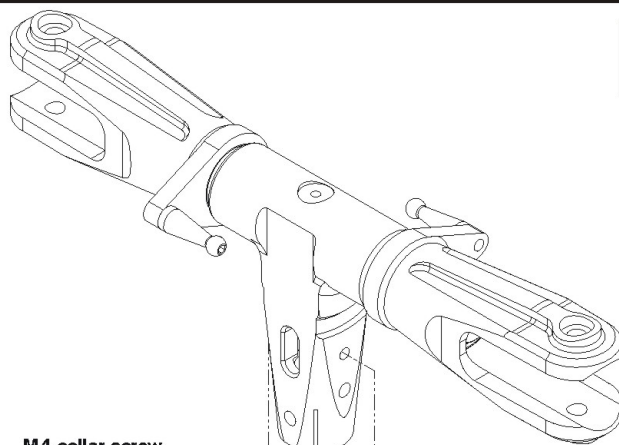

M4 collar screw
M4雙層軸套螺絲
M4x10mm

Metal flybar seesaw holder
金屬平衡桿固定座

Collar
擺臂軸承襯套
φ3xφ4.8x1.5mm

Bearing 683ZZ
683ZZ軸承
φ3xφ7x3mm

Washer
華司
φ3xφ4.8x0.3mm

Socket button head screw
半圓頭內六角螺絲
M3x12mm

Bearing MR104ZZ
MR104ZZ軸承
φ4xφ10x4mm

Bearing MF105ZZ
MF105ZZ軸承
φ5xφ11.2xφ10x4mm

Washer
華司
φ3xφ4.8x0.3mm

Linkage ball B(M3x4)
球頭B(M3x4)
φ5x12mm

Metal SF Mixing arm
金屬SF控制搖臂

700NH2A

Socket button head screw
半圓頭內六角螺絲(M3x12mm) x 2

M4 collar screw
M4雙層軸套螺絲(M4x10mm) x 2

Washer
華司(φ3xφ4.8x0.3mm) x 4

700NH3

Socket screw
圓頭內六角螺絲(M3x5mm) x 4

M4 Set screw
M4止洩螺絲(M4x4mm) x 2

Linkage rod(B)
連桿(B) φ1.96x22mm x 2

Ball link
連桿頭 x 4

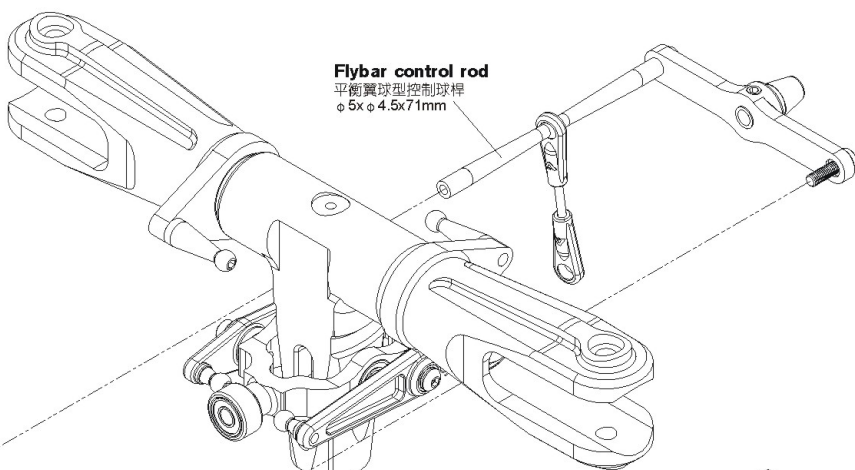

Flybar control rod
平衡簧球型控制球桿
φ5xφ4.5x71mm

Flybar rod
平衡桿
φ4x57.0mm

700NT3B

M4 Set screw
M4止洩螺絲
M4x4mm

Metal flybar control arm
金屬平衡翼控制臂

Socket screw
圓頭內六角螺絲
M3x5mm

Assemble linkage rod (B) before assembling flybar control set.
組裝平衡翼控制組先將連桿裝入。

Linkage rod(B)
Approx 45mm x 2
連桿(B)約45mm x 2

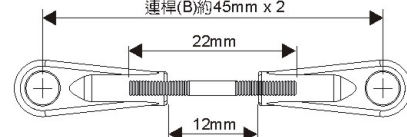

700NH4

 Apply a little amount of T43 thread lock when fixing a metal part.
螺絲鎖附於金屬件請使用適量T43 (螺絲膠)



Bearing 683ZZ
683ZZ軸承(φ3xφ7x3mm) x 4



Bearing FMR52ZZ
FMR52Z軸承(φ2xφ5x2.3mm) x 4



Socket screw
圓頭內六角螺絲(M2x5mm) x 4



Socket button head screw
半圓頭內六角螺絲(M3x12mm) x 2



Washer
華司(φ3xφ4.8x0.3mm) x 4



Collar
擺臂軸承襯套(φ3xφ4.8x1.5mm) x 2

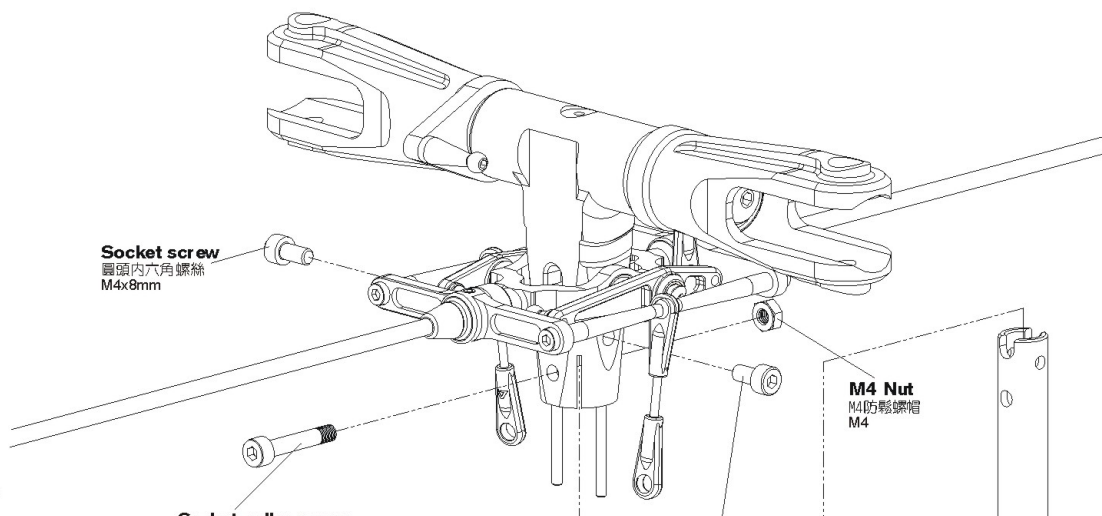

Socket screw
圓頭內六角螺絲
M4x8mm

Socket collar screw
圓頭內六角軸套螺絲
M4x24mm

Socket screw
圓頭內六角螺絲
M4x8mm

M4 Nut
M4防鬆螺帽
M4

Main shaft
主軸
φ8xφ12x212.5mm

700NH4A



Linkage ball B(M3x4)
球頭B(M3x4)(φ5x12mm) x 2



Socket screw
圓頭內六角螺絲(M4x8mm) x 2

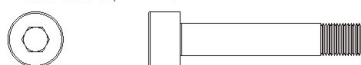

Socket collar screw
圓頭內六角軸套螺絲(M4x24mm) x 1



M4 Nut
M4防鬆螺帽 x 1

700NH5A



Linkage ball B(M3x4)
球頭B(M3x4)(φ5x12mm) x 7

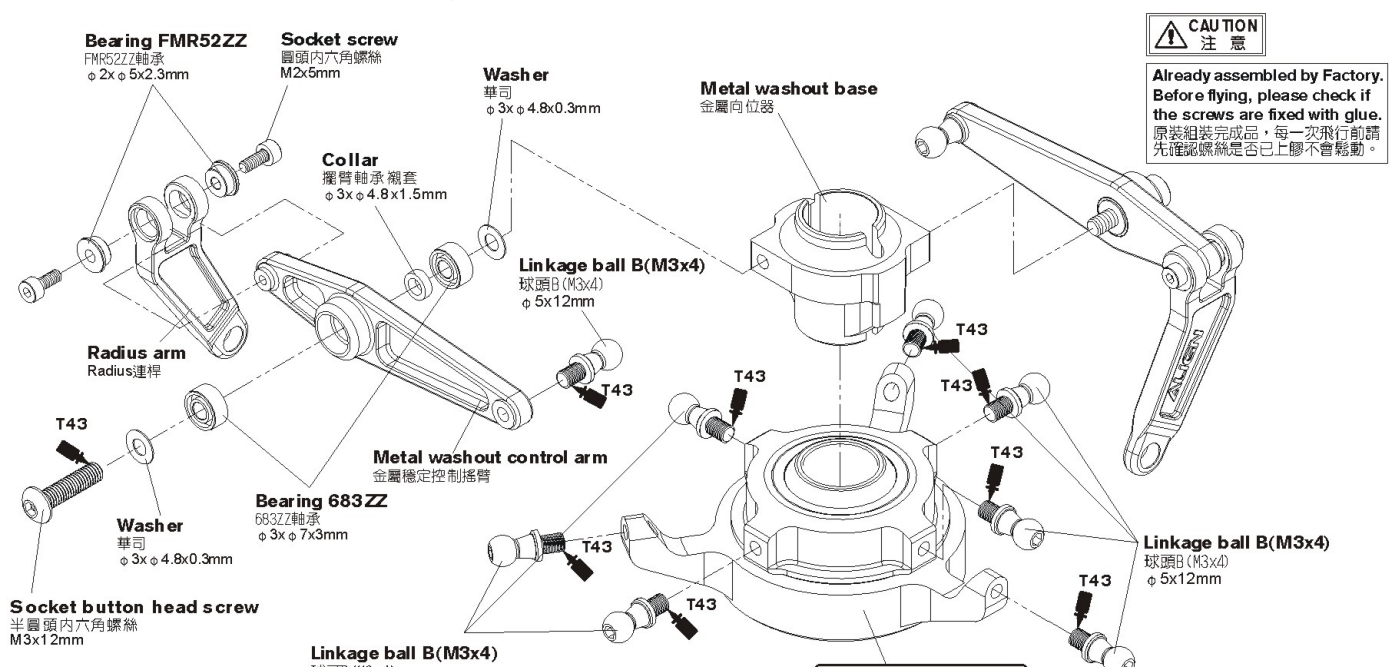

CAUTION
注意

Already assembled by Factory.
Before flying, please check if the screws are fixed with glue.
原裝組裝成品，每一次飛行前請先確認螺絲是否已上膠不會鬆動。

Bearing FMR52ZZ
FMR52Z軸承
φ2xφ5x2.3mm

Socket screw
圓頭內六角螺絲
M2x5mm

Washer
華司
φ3xφ4.8x0.3mm

Metal washout base
金屬向位器

Collar
擺臂軸承襯套
φ3xφ4.8x1.5mm

Linkage ball B(M3x4)
球頭B(M3x4)
φ5x12mm

Radius arm
Radius連桿

T43

Washer
華司
φ3xφ4.8x0.3mm

Bearing 683ZZ
683ZZ軸承
φ3xφ7x3mm

Metal washout control arm
金屬穩定控制搖臂

Socket button head screw
半圓頭內六角螺絲
M3x12mm

Linkage ball B(M3x4)
球頭B(M3x4)
φ5x12mm

Linkage ball B(M3x4)
球頭B(M3x4)
φ5x12mm

700NH5

700NZ2

Apply a little amount of T43 thread lock when fixing a metal part.
螺絲鎖附於金屬件請使用適量T43(螺絲膠)

Linkage rod(A)
連桿(A) ϕ 1.96x14mm x 2

Linkage rod(C)
連桿(C) ϕ 1.96x50mm x 2

700NZ2A

Ball link
連桿頭 x 8

700NH2A

Socket screw
圓頭內六角螺絲(M3x10mm) x 1

Socket screw
圓頭內六角螺絲
M3x10mm

Head stopper
旋翼頭制動器

Linkage rod(A)
Approx 33mm x 2
連桿(A)約33mm x 2

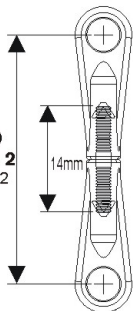

Flybar paddle
平衡翼

Linkage rod(C)
Approx 77mm x 2
連桿(C)約77mm x 2

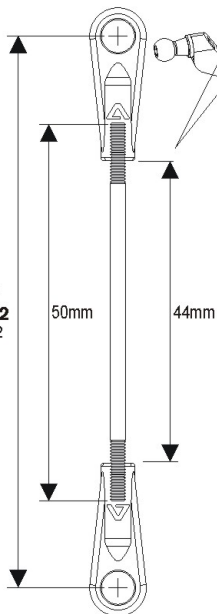

Linkage rod(B)
Approx 45mm x 2
連桿(B)約45mm x 2

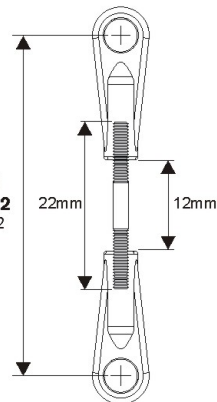

Approx 217mm
約21.7mm

Approx 217mm
約21.7mm

Flybar paddle
平衡翼

Flybar paddle
平衡翼

Make sure both sides are equal in length.
請保持平衡桿兩邊長度相等。

700NB3

Socket button head screw
半圓頭內六角螺絲
M3x6mm

Main drive gear
主齒盤
164T

CAUTION 注意

Already assembled by Factory. Before flying, please check if the screws are fixed with glue. 原裝組裝完成品，每一次飛行前請先確認螺絲是否已上膠不會鬆動。

One-way bearing shaft
單向軸承套
φ 12x φ 15x41.5mm

Apply grease
塗上潤滑油

Autorotation tail drive gear
尾驅動齒
150T

Bearing 6702ZZ
6702ZZ軸承(φ 15x φ 21x4mm) x 1

One-way bearing collar
單向軸承外環
φ 6x φ 23x11.6mm

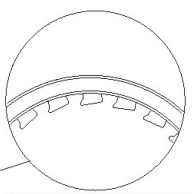

Please note the direction of bearing.
請注意軸承方向

One-way bearing cover
單向軸承上蓋
φ 21x φ 15.8x26mm

One-way bearing
單向軸承
φ 15x φ 23x11mm

Socket screw
圓頭內六角螺絲
M2.5x9mm

Before tightening the screw, please rotate the bearing and check the concentricity of the bearing. Then apply some glue evenly on the screw and tighten it firmly, to avoid the bearing stuck or heavy load at one side and cause slip.

上緊螺絲前需試轉動確認軸承同心度良好後，才能將螺絲平均上膠鎖緊，以避免造成卡死或單向重負載可能產生的打滑。

Bearing 6702ZZ
6702ZZ軸承
φ 15x φ 21x4mm

One-way bearing mount
單向軸承下座
φ 21x φ 6.5x33.1mm

One-way bearing
單向軸承(φ 15x φ 23x11mm) x 1

Socket screw
圓頭內六角螺絲(M2.5x8mm) x 6

Socket button head screw
半圓頭內六角螺絲(M3x6mm) x 6

700NB4A

M4 Set screw
M4止洩螺絲(M4x4mm) x 2

Clutch nut
離合器齒輪螺帽(φ 14x6mm) x 1

Bearing 695ZZ
695ZZ軸承(φ 5x φ 13x4mm) x 2

Bearing 6800ZZ
6800ZZ軸承(φ 10x φ 19x5mm) x 2

M4 Set screw
M4止洩螺絲
M4x4mm

Starter coupling
六角啟動頭
φ 8x φ 10x18mm

Apply a little amount of T43 thread lock when fixing a metal part. 螺絲鎖附於金屬件請使用適量T43(螺絲膠)

M3 Nut
M3防鬆螺帽

Bearing 695ZZ
695ZZ軸承
φ 5x φ 13x4mm

M4 Set screw
M4止洩螺絲
M4x4mm

Socket screw
圓頭內六角螺絲
M3x8mm

Clutch nut
離合器齒輪螺帽
φ 14x6mm

Bearing 6800ZZ
6800ZZ軸承
φ 10x φ 19x5mm

Socket screw
圓頭內六角螺絲
M3x8mm

Hex mounting bolt
六角機身鉗柱
φ 2.5x60.5mm

Clutch gear
離合器齒輪
φ 7x φ 15.4x40.9mm

Clutch bearing block
離合器軸承座

Option equipment: Magnet (Governor sensor)
另購：定速感應磁鐵

700NB4B

Socket screw
圓頭內六角螺絲(M3x8mm) x 2

M3 Nut
M3防鬆螺帽 x 2

Clutch bell
離合器輪
φ 51x φ 56x20.5mm

Bearing 695ZZ
695ZZ軸承
φ 5x φ 13x4mm

Clutch liner
離合器來令片
1x9x158mm

Already assembled by factory, please note to check again. 已組裝完成，請務必自行再確認。

Clutch/Start shaft
啟動軸
φ 5x φ 12x82mm

700NB1A



Socket button head collar screw
半圓頭內六角軸套螺絲(M3x10mm) x 2



Linkage ball C (M3x3.5)
球頭C (M3x3.5) (φ5x8.5mm) x 2



Socket button head screw
半圓頭內六角螺絲(M3x12mm) x 1



Socket screw
圓頭內六角螺絲(M3x14mm) x 1



M3 Specialty washer
M3特殊華司(φ3xφ8x2mm) x 2



Socket screw
圓頭內六角螺絲(M3x12mm) x 1

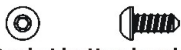

Socket button head self tapping screw
半圓頭內六角自攻螺絲(T2.6x6mm) x 1



Washer
華司(φ3xφ4.8x0.3mm) x 2



Washer
華司(φ3xφ8x1mm) x 1

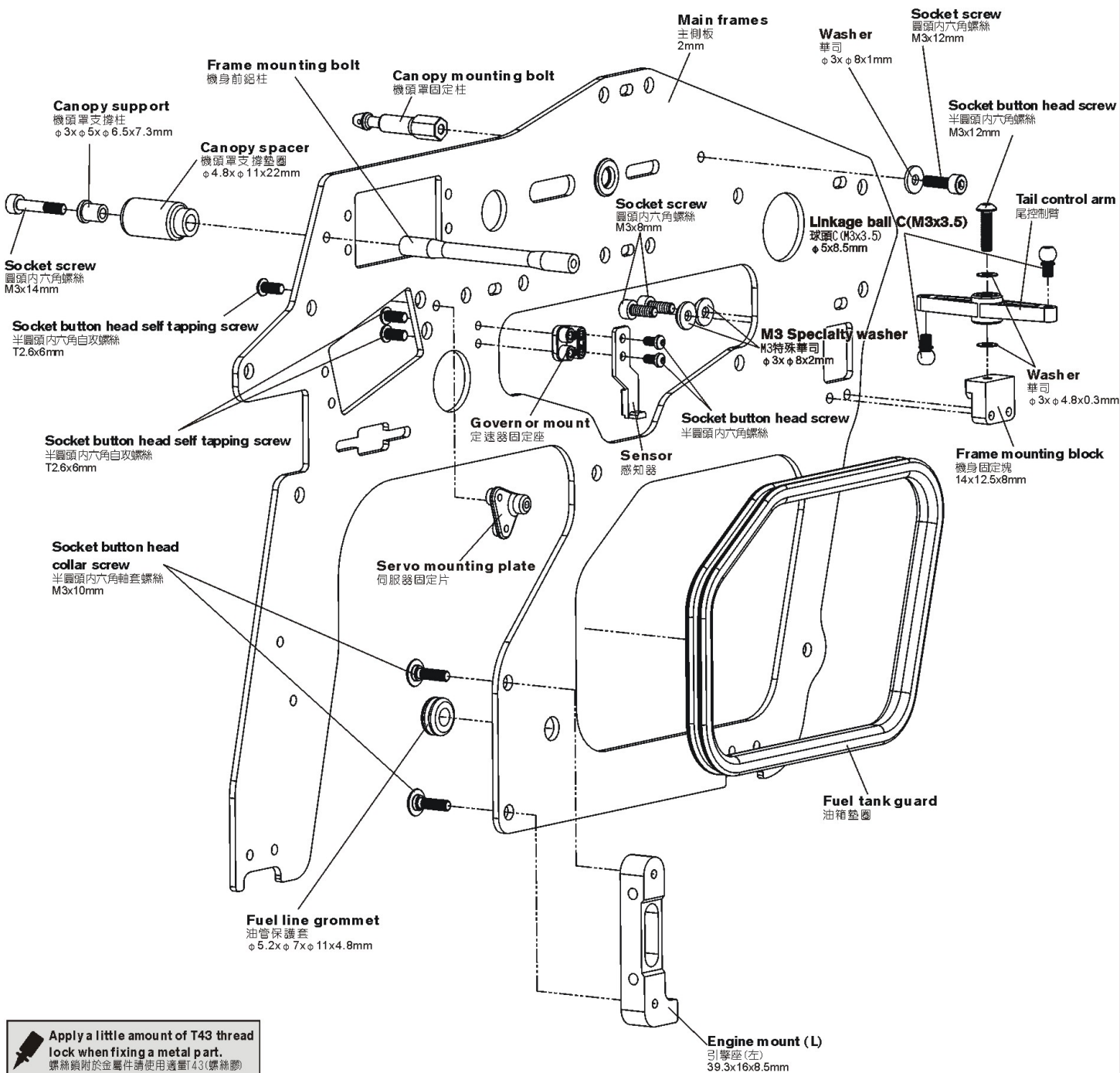

Apply a little amount of T43 thread lock when fixing a metal part.
螺絲鎖附於金屬件請使用適量T43(螺絲膠)

700NB1A



Socket button head collar screw
半圓頭內六角軸套螺絲(M3x10mm) x 18



Socket screw
圓頭內六角螺絲(M3x14mm) x 1



Socket button head self tapping screw
半圓頭內六角自攻螺絲(T2.6x6mm) x 1

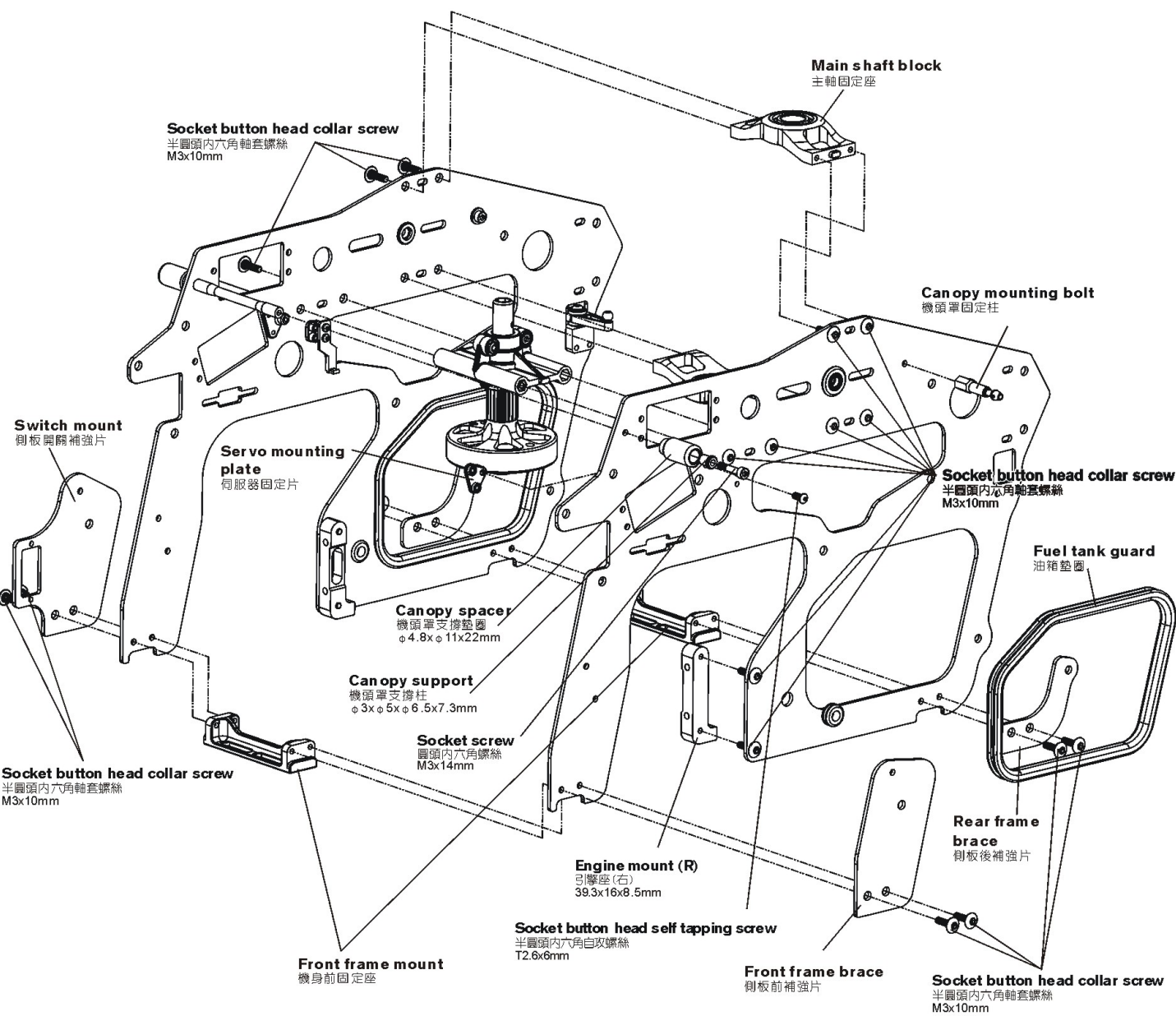

700NB4A



Socket screw

圓頭內六角螺絲(M3x12mm) x 2



Socket head spring screw

圓頭內六角彈簧螺絲(M4x8mm) x 2



Socket button head screw

半圓頭內六角螺絲(M4x5mm) x 4

Socket button head collar screw

半圓頭內六角軸套螺絲 M3x10mm

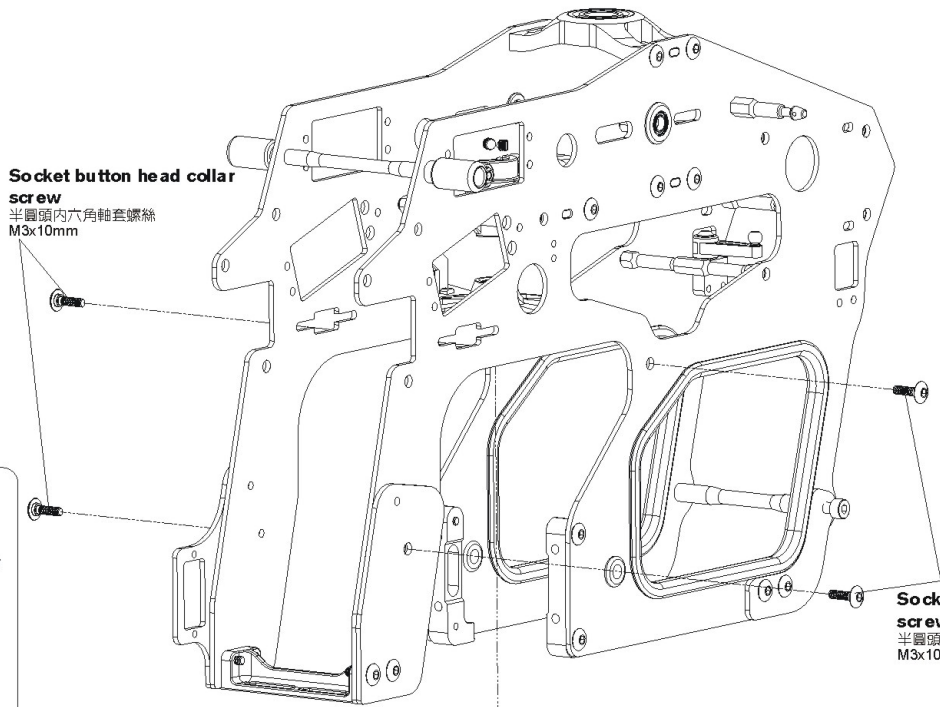

700NB4B



Socket button head collar screw

半圓頭內六角軸套螺絲(M3x10mm) x 4



Socket screw

圓頭內六角螺絲(M4x16mm) x 4



M4 Washer

M4華司(φ4xφ10x1mm) x 4

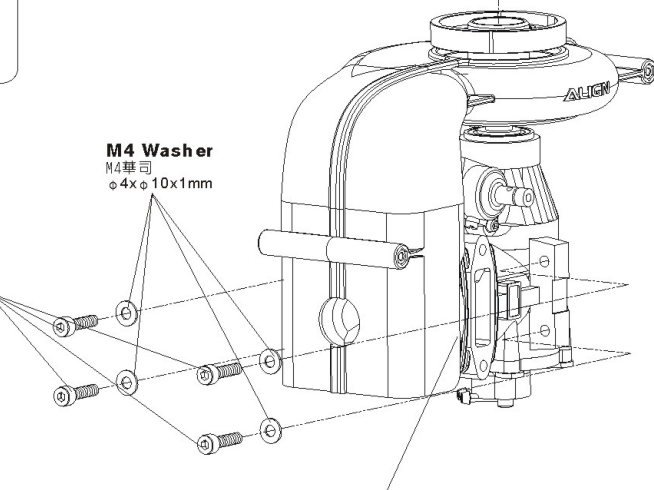

M4 Washer

M4華司
φ4xφ10x1mm

Socket screw

圓頭內六角螺絲
M4x16mm

Socket button head collar screw

半圓頭內六角軸套螺絲
M3x10mm

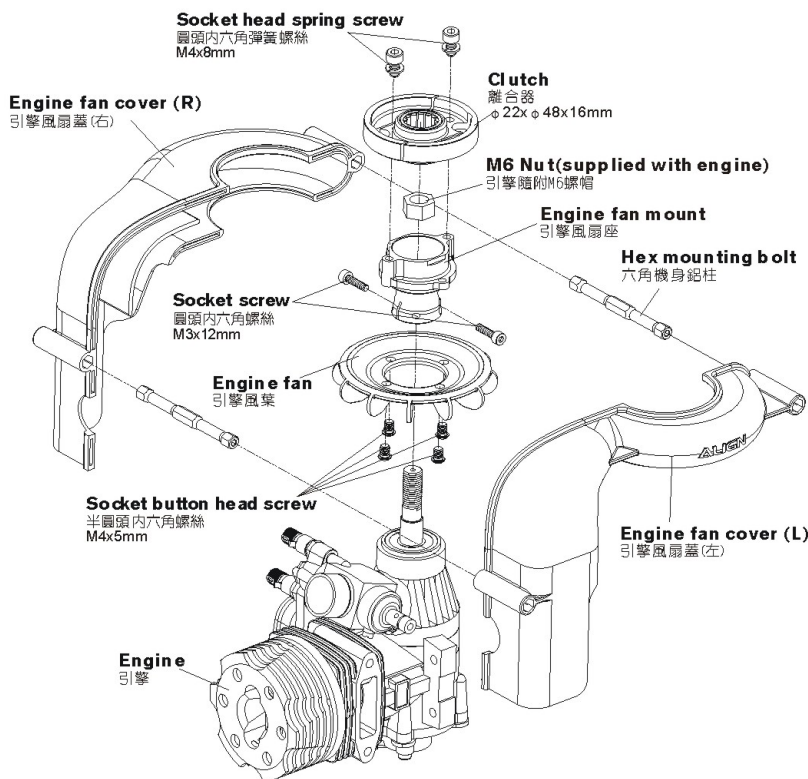

Socket head spring screw

圓頭內六角彈簧螺絲
M4x8mm

Engine fan cover (R)

引擎風扇蓋(右)

Clutch

離合器
φ22xφ48x16mm

M6 Nut(supplied with engine)

引擎隨附M6螺帽

Engine fan mount

引擎風扇座

Hex mounting bolt

六角機身鉚柱

Socket screw

圓頭內六角螺絲
M3x12mm

Engine fan

引擎風扇

Socket button head screw

半圓頭內六角螺絲
M4x5mm

Engine fan cover (L)

引擎風扇蓋(左)

Engine

引擎

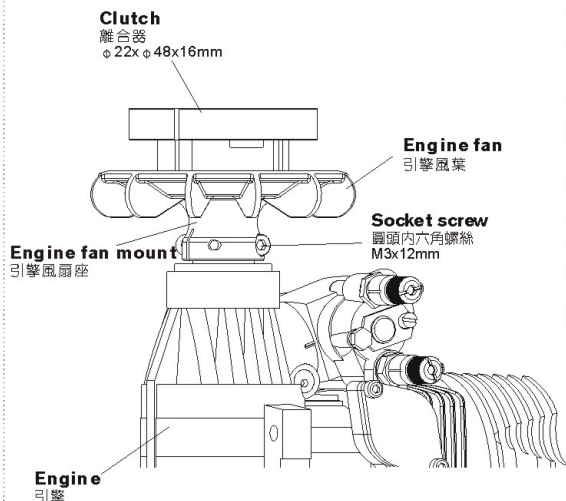

Clutch

離合器
φ22xφ48x16mm

Engine fan

引擎風扇

Socket screw

圓頭內六角螺絲
M3x12mm

Engine fan mount

引擎風扇座

Engine

引擎

After install the engine into the model, please loosen the fixing screw and adjust the carburetor and the engine are at an angle of 90° (Vertical).

引擎裝入機體後請鬆開固定螺絲將化油器調成與引擎垂直。

Apply a little amount of T43 thread lock when fixing a metal part.
螺絲鎖附於金屬件請使用適量T43(螺絲膠)

Main frame assembly point:

First do not fully tighten the screws of main frames and put two bearings through the main shaft to check if the movements are smooth. The bottom bracket must be firmly touched the level table top (glass surface); please keep the smooth movements on main shaft and level bottom bracket, then slowly tighten the screws. This assembly can help for the power and flight performance.

機身側板組立重點:

側板螺絲先不完全鎖緊，放入主軸貫穿二顆軸承確認上下移動必需滑順，主體底板必須與水平桌面（玻璃平面）踏實緊貼；請保持主軸滑順與底板平行桌面後慢慢鎖緊螺絲。正確側板的組裝對動力與飛行性能有顯著幫助。

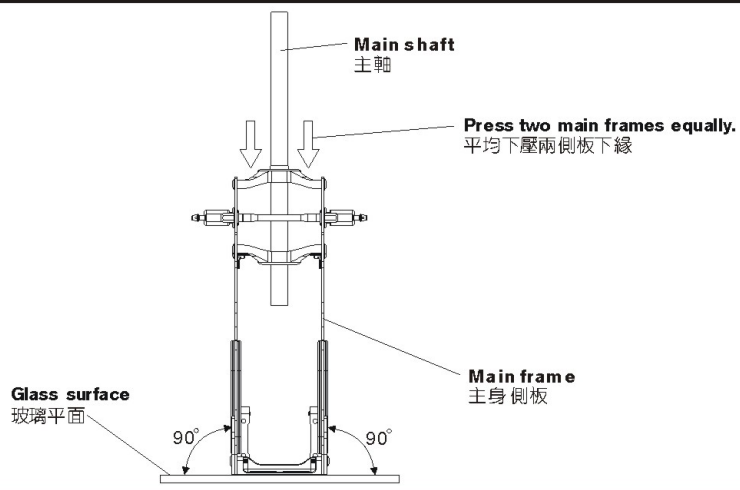

700NB5A

700NG1

Apply a little amount of T43 thread lock when fixing a metal part.
螺絲鎖附於金屬件請使用適量T43(螺絲膠)

- Socket button head collar screw**
半圓頭內六角軸套螺絲(M3x10mm) x 6
- M3 Set screw**
M3止洩螺絲(M3x15mm) x 2

- Socket screw**
圓頭內六角螺絲(M3x12mm) x 4
- M3 Set screw**
M3止洩螺絲(M3x4mm) x 4
- M3 Washer**
M3華司(φ3xφ8x1mm) x 4

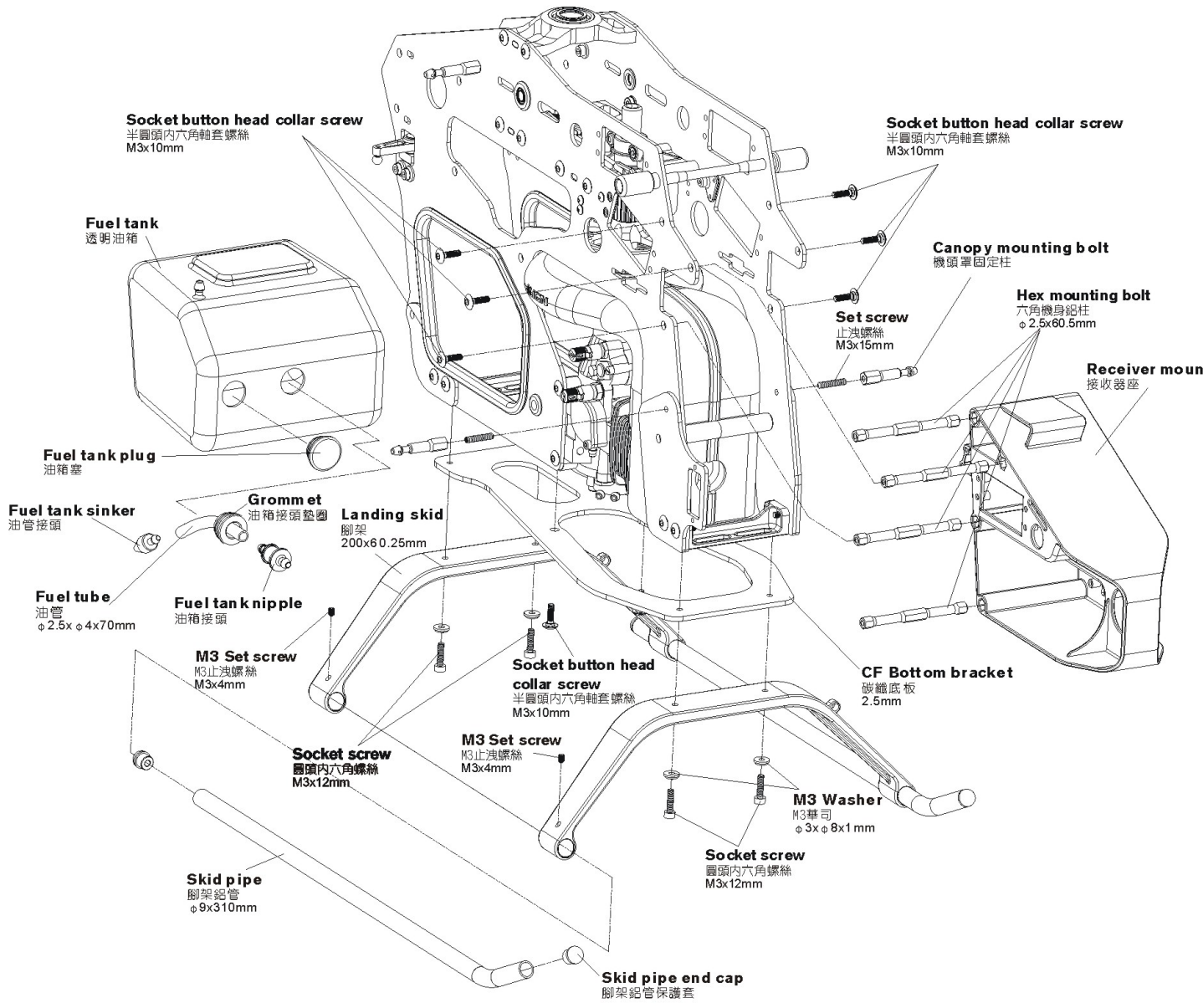

700NZ4



Linkage ball C (M2x5)

球頭C (M2x5) (φ5x10mm) x 5



Socket button head self tapping screw

半圓頭內六角自攻螺絲(T2.6x12mm) x 12



M2 Nut

M2螺帽 x 5

700NB5A



Socket button head self tapping screw

半圓頭內六角自攻螺絲(T2.6x12mm) x 4

700NT3BA



Ball link

連桿頭 x 2

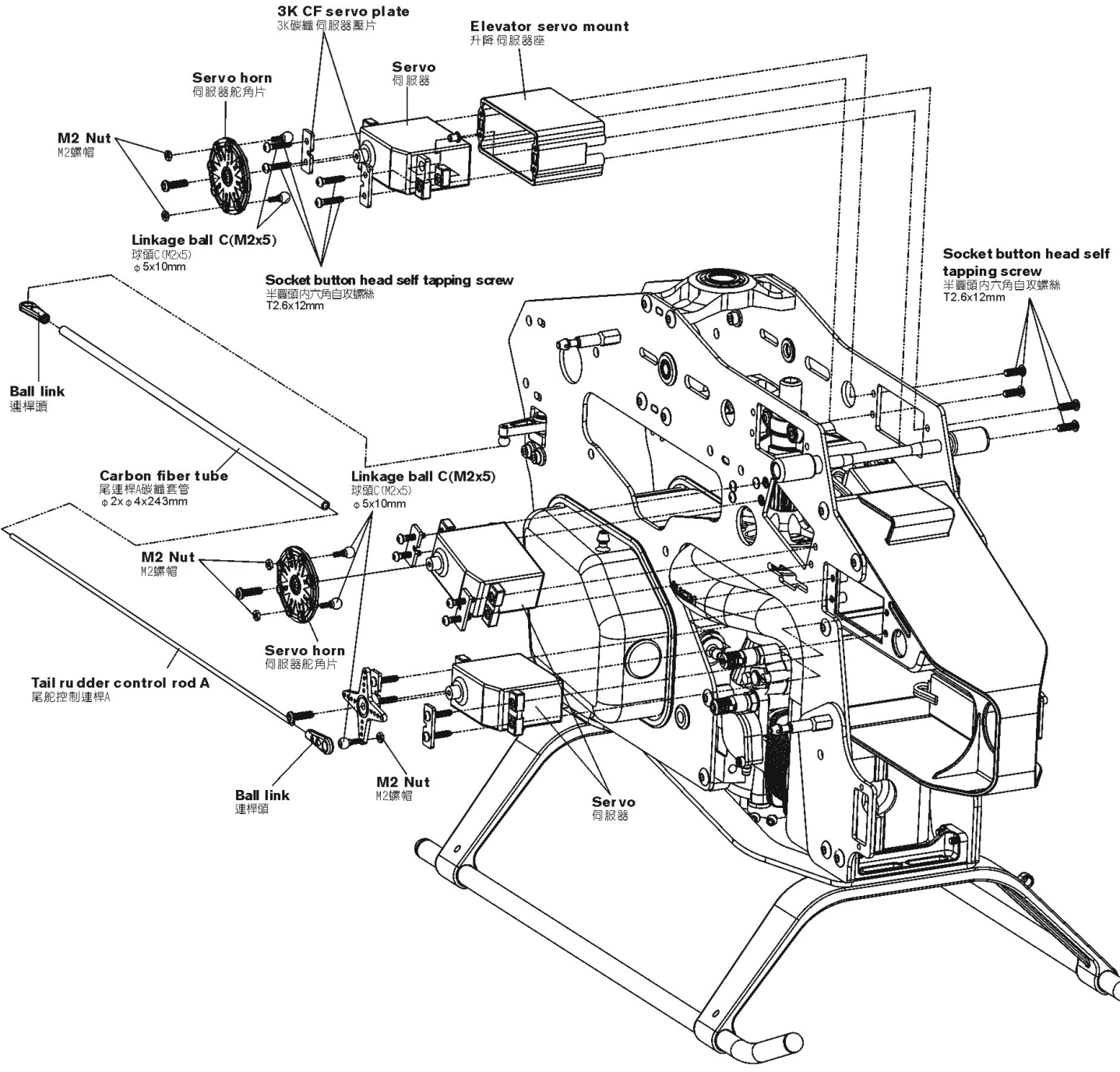

700NB1



Bearing MR95ZZ
MR95ZZ軸承(φ5xφ9x3mm) x 4



Socket button head screw
半圓頭內六角螺絲(M3x6mm) x 2



Socket screw
圓頭內六角螺絲(M3x12mm) x 1



M4 Set screw
M4止洩螺絲(M4x4mm) x 1



Control shaft collar
連動桿套圈(φ5xφ7.5x3mm) x 2



Elevator ball link
升降臂連桿頭

700NB1A



Linkage ball C(M3x3.5)
球頭C(M3x3.5)(φ5x8.5mm) x 8



Socket button head screw
半圓頭內六角螺絲(M3x8mm) x 2



Bearing F683ZZ
F683ZZ軸承(φ3xφ7x3mm) x 2



Washer
華司(φ3xφ5.5x0.3mm) x 2

700NZ2A



Ball link
連桿頭 x 12

700NZ2

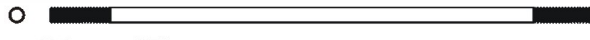

Linkage rod(E)
連桿(E) φ1.96x72mm x 2

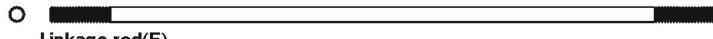

Linkage rod(F)
連桿(F) φ1.96x87mm x 4

Linkage rod(E)
Approx 92mm x 2
連桿(E)約92mm x 2

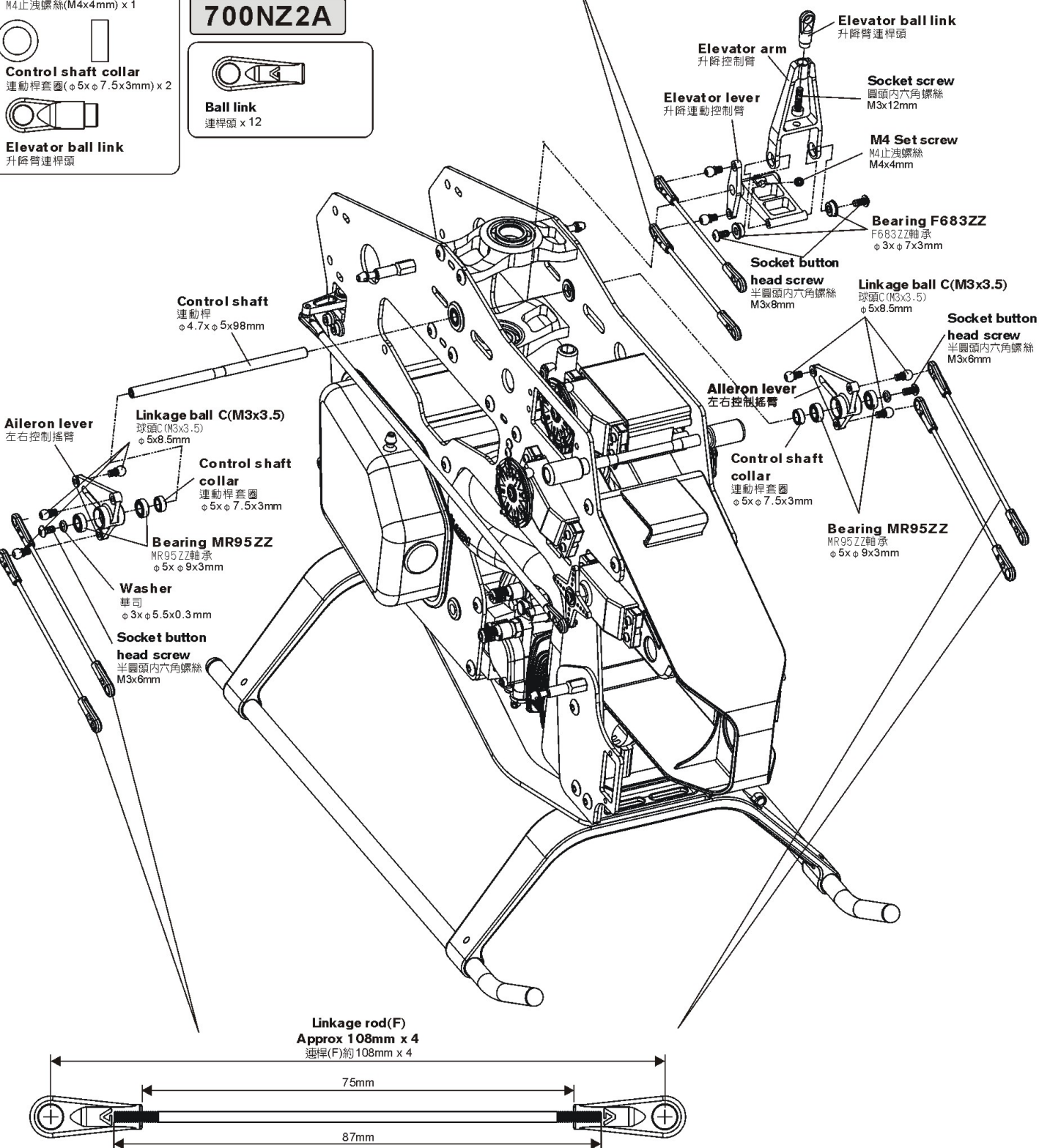

Fan cover fixing Tip

風扇罩固定要領

Before fixing the engine fan cover, please use a starter to rotate the fan and move the fan cover. This is to make sure no any interference, and then secure the fan cover with a fixing screw.

鎖緊固定引擎散熱風罩前，請先使用啟動棒轉動風扇，並移動風扇罩，確認在風扇無碰觸風扇罩後才鎖緊風扇罩固定螺絲。

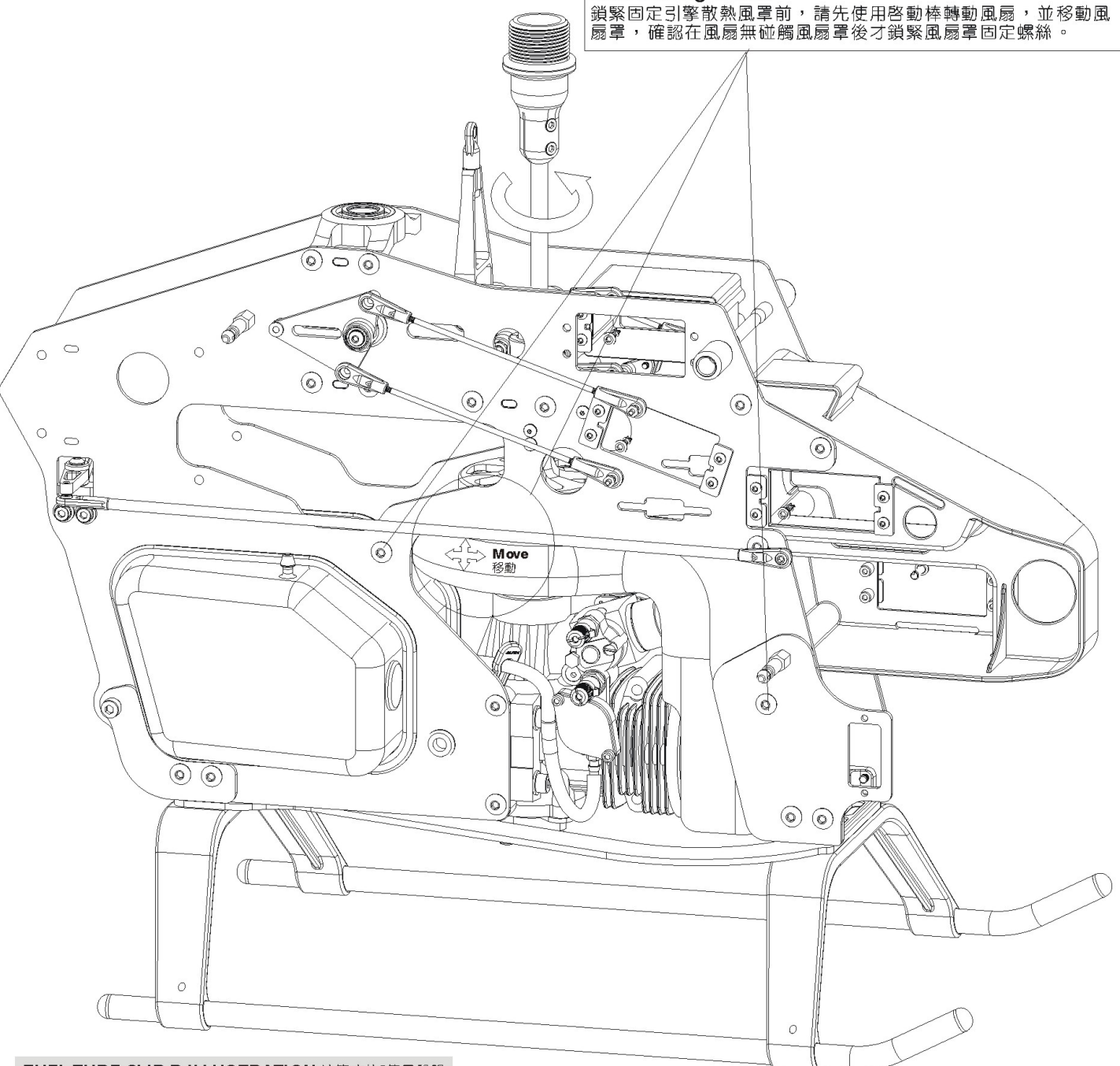

FUEL TUBE CLIP B ILLUSTRATION 油管夾片B使用說明

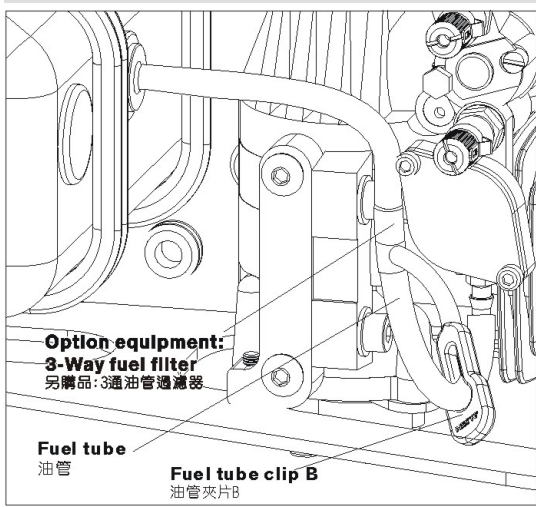

FUEL TUBE CLIP ILLUSTRATION 油管夾片使用方法

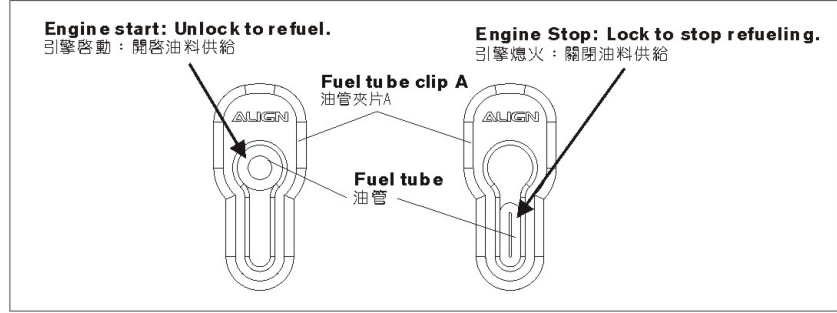

700NT1

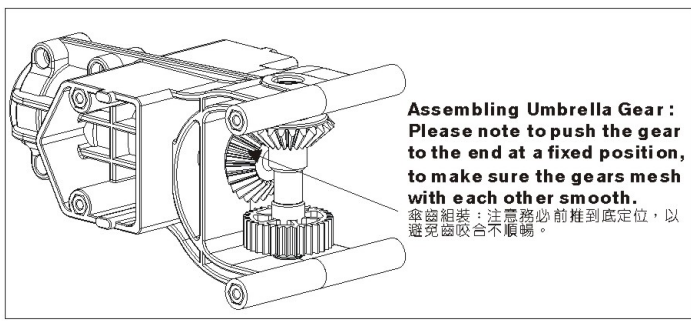
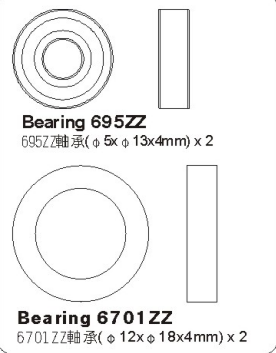
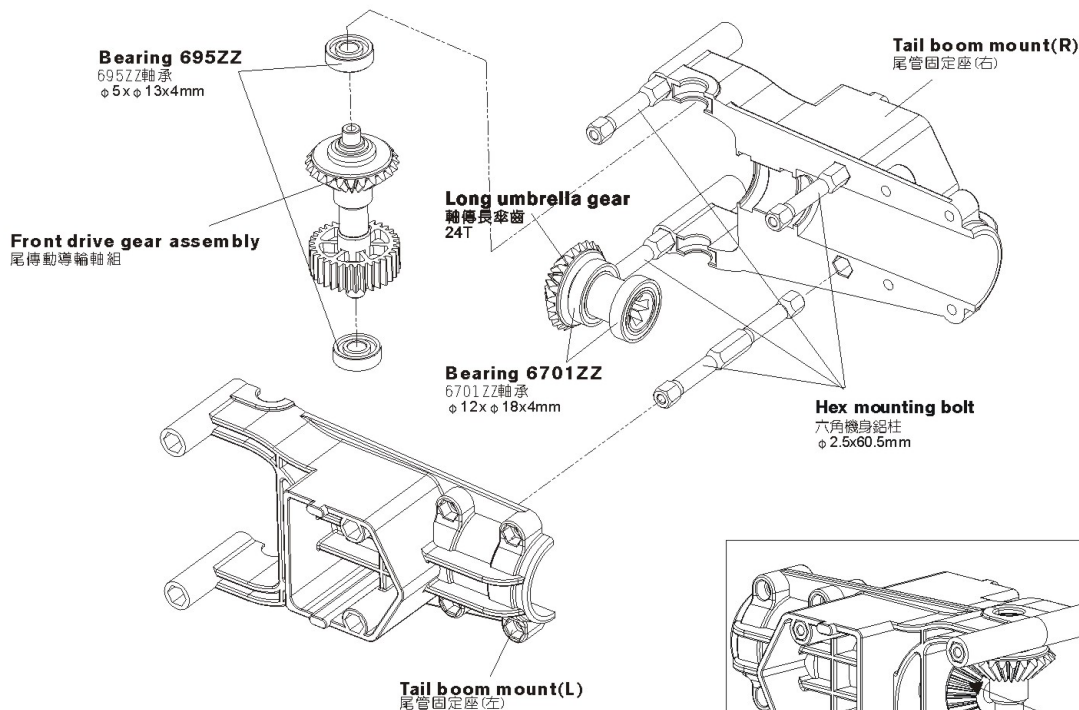

700NT2A

Apply a little amount of T43 thread lock when fixing a metal part. 螺絲鎖附於金屬件請使用適量T43(螺絲膠)

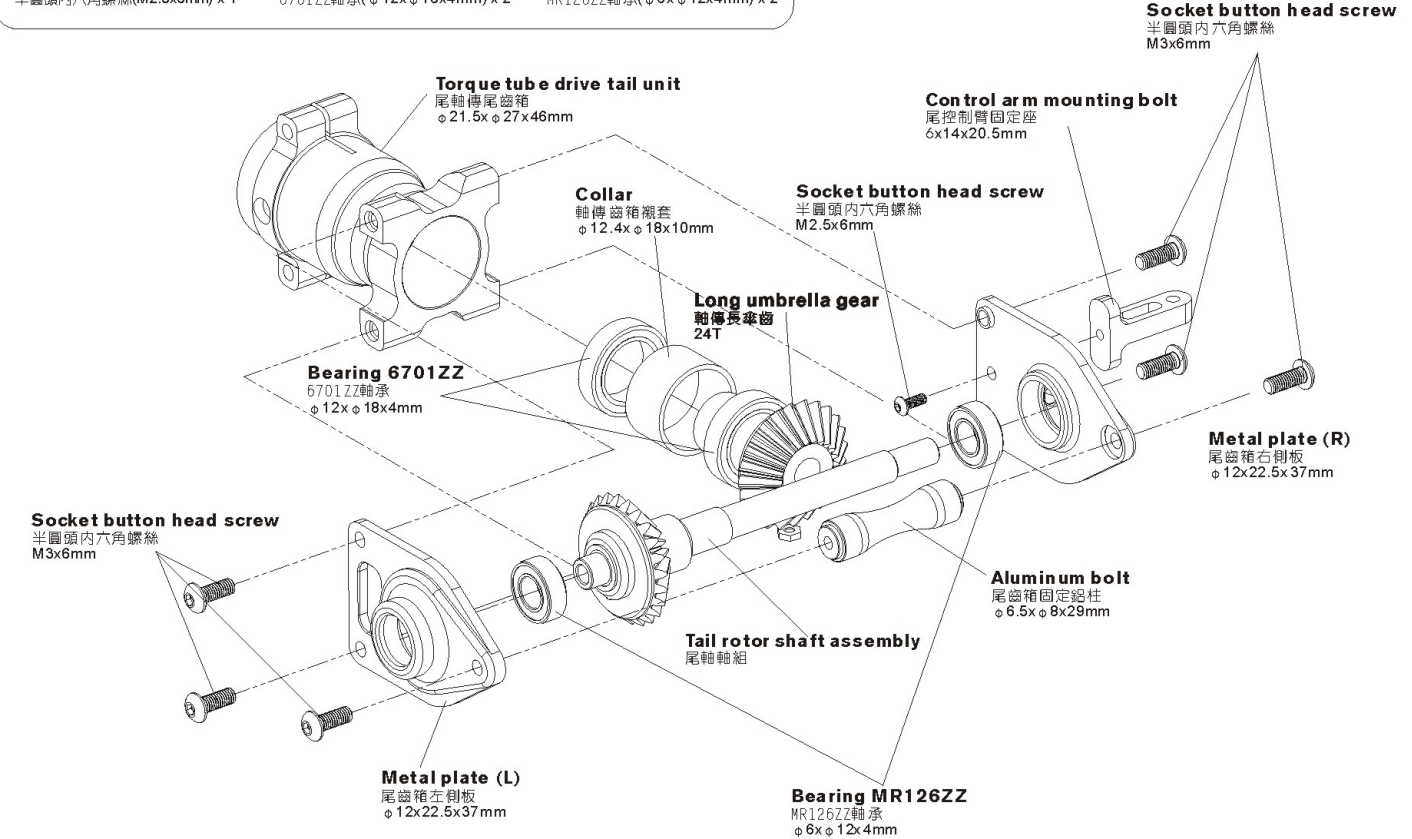

Already assembled by factory, please note to check again.
已組裝完成，請務必自行再確認。

Socket screw
圓頭內六角螺絲
M3x14mm

When assembling into the tail boom, please apply some oil on the surface, to make it smooth during the assembling and keep it vertical with the torque tube for smooth rotation.
插入尾管內時，外表抹些潤滑油，以確保平順壓入尾管中並與尾傳動軸保持垂直，讓尾輪傳動順暢。

Torque tube
尾傳動軸桿

When assembling the tail boom, please aim at the fixing hole 5.
插入尾管時請注意孔對準尾管 5 固定孔

M3 Nut
M3防鬆螺帽

Vertical stabilizer m mount
垂直固定座

Tail control guide
尾控制桿固定環

Socket collar screw
圓頭內六角軸套螺絲
M3x22mm

M3 Specialty washer
M3特殊華司
φ3xφ8x2mm

3K CF Horizontal stabilizer
3K碳纖維水平翼

3K Tail boom
3K碳纖維尾管
785mm

M3 Specialty washer
M3特殊華司
φ3xφ8x2mm

Ball link
連桿頭

Tail rudder control rod B
尾舵控制連桿B

Stabilizer mount (Upper)
水平翼固定上座

Socket collar screw
圓頭內六角軸套螺絲
M3x26mm

Tail boom brace end
尾管支撐架接頭

Before assembling, please wrap the tail boom with a scotch tape (Thickness 0.03~0.05mm) to avoid the mount slipping.
安裝前請先用透明膠帶(0.03~0.05mm厚)包裹尾管，可防止固定座滑動。

Tail control guide
尾控制桿固定環

3K CF Vertical stabilizer
3K碳纖維垂直翼

Tail boom brace
尾管支撐架

Socket screw
圓頭內六角螺絲
M4x10mm

M4 Washer
M4華司
φ4xφ10x1mm

Stabilizer mount (Lower)
水平翼固定下座

Ball link
連桿頭

700NT1A



Socket screw
圓頭內六角螺絲(M3x14mm) x 4



M3 Nut
M3防鬆螺帽 x 4

700NT2A



Socket collar screw
圓頭內六角軸套螺絲(M3x26mm) x 2

700NT2EA



Socket screw
圓頭內六角螺絲(M4x10mm) x 2



Socket collar screw
圓頭內六角軸套螺絲(M3x22mm) x 2



M3 Specialty washer
M3特殊華司(φ3xφ8x2mm) x 4

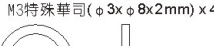

M4 Washer
M4華司(φ4xφ10x1mm) x 2

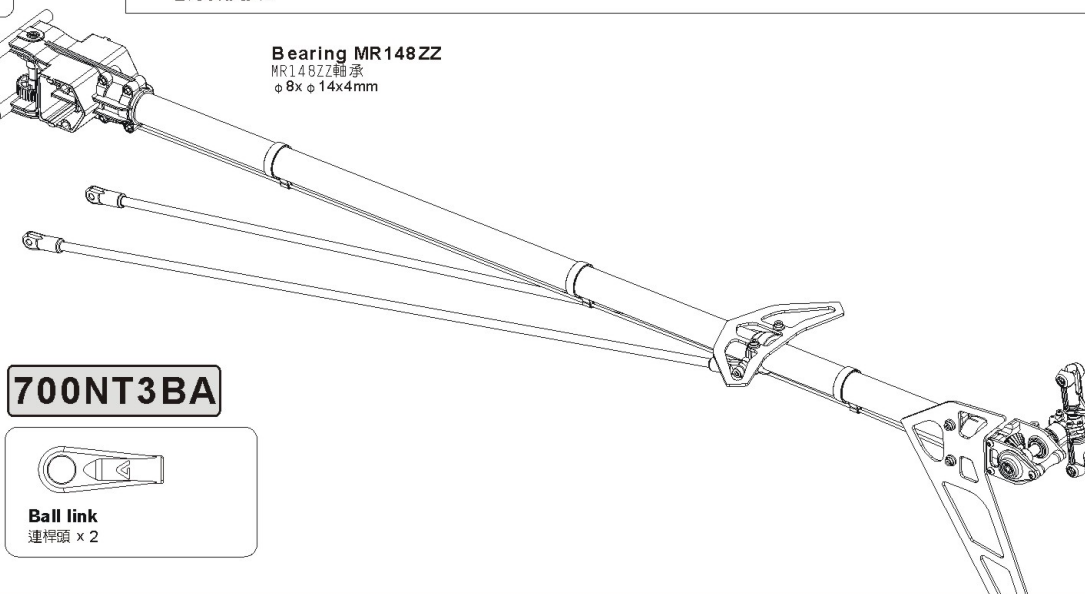

Tip to fix the torque tube 傳動軸軸承固定定位要領

Please apply some CA glue to fix MR148 bearing on the torque tube, avoid CA glue adhering to the dust cover or it may cause the bearing stuck. When assembling into the tail boom, please apply some oil and use the attached PVC packing tube to press the bearing holder of the torque tube into the tail boom horizontally.

請以少量CA將MR148軸承固定於尾傳動軸上，避免CA沾到軸承的防塵蓋而導致軸承卡死，插入尾管內時，尾傳動軸承墊圈外表抹些潤滑油，利用隨附PVC封裝管將尾傳動軸承墊圈平行壓入尾管中不可歪斜。

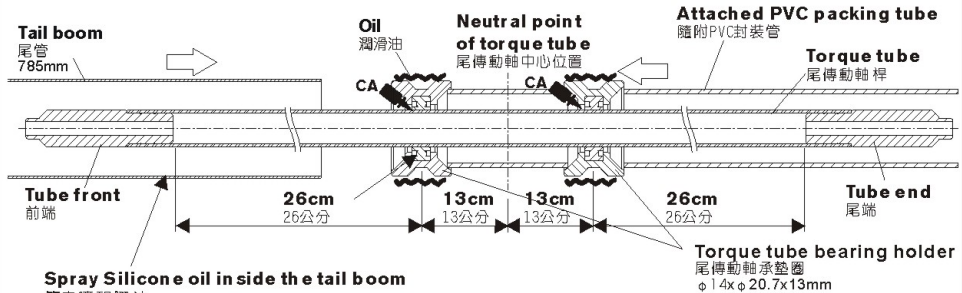

Spray Silicone oil in side the tail boom
管內噴砂膠油

Bearing MR148ZZ
MR148ZZ軸承
φ8xφ14x4mm

700NT3BA

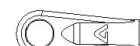

Ball link
連桿頭 x 2

700NT1A



Socket button head collar screw
半圓頭內六角軸套螺絲(M3x10mm) x 8

700NZ2



Throttle linkage rod
油門連桿 ϕ 1.96x87mm x 1

700NZ2A



Ball link
連桿頭 x 2

700NB1A

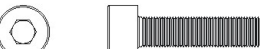

Socket screw
圓頭內六角螺絲(M4x16mm) x 2



M4 Washer
M4華司(ϕ 4x ϕ 10x1mm) x 2

Please assemble the G linkage rods inside the servo horns to avoid any interference caused by the canopy.
G連桿請裝於伺服臂內側確保動作時不碰觸機頭罩

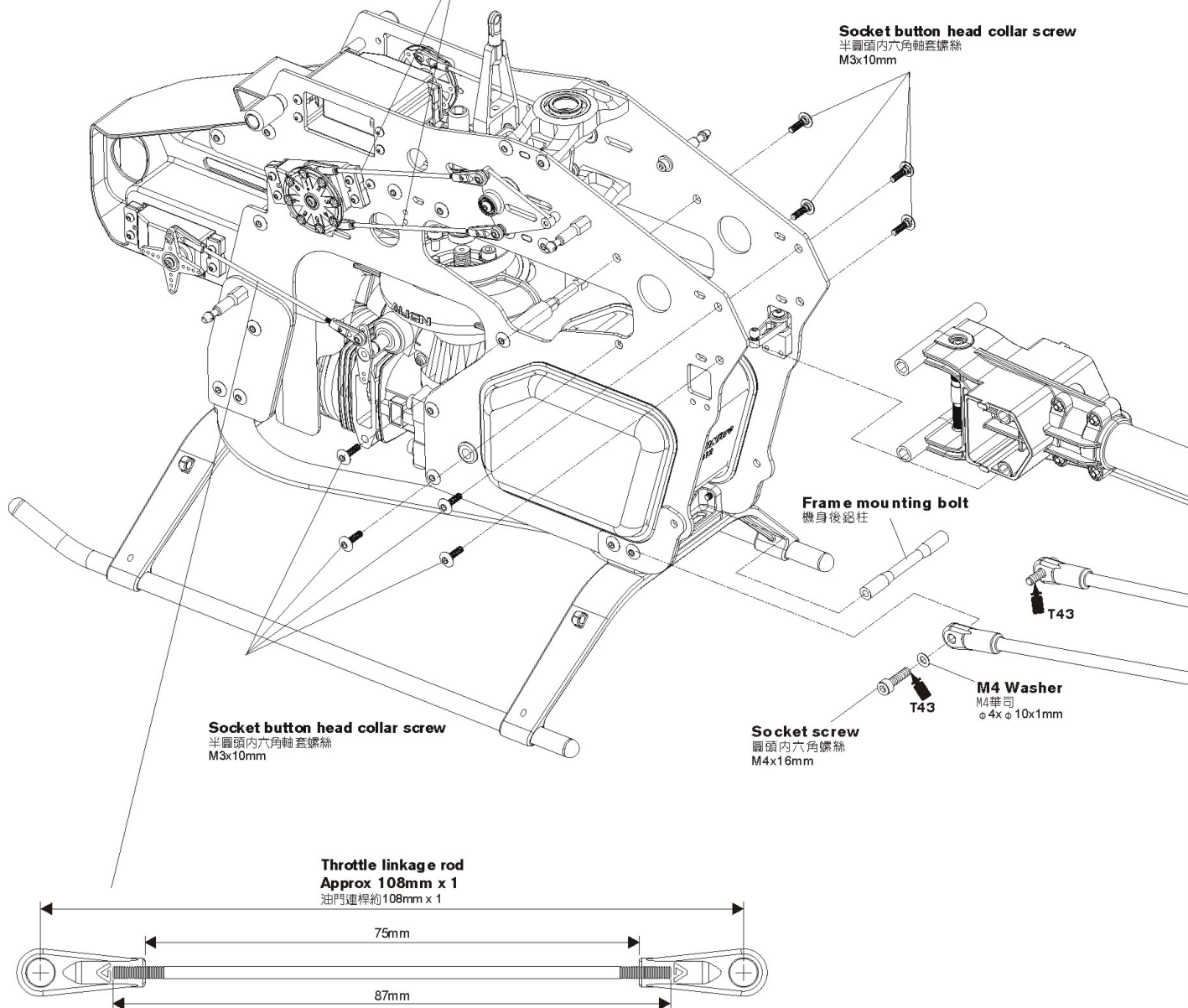

CAUTION 注意
When tightening a screw to a plastic part, please tighten it firmly, but not over tightened, or they will strip.
螺絲鎖入塑膠件請務必注意，適當扭力鎖緊即可，而過緊的扭力可能會導致滑牙。

700NB3

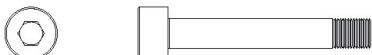

Socket collar screw
圓頭內六角軸套螺絲(M4x27mm) x 1



M4 Nut
M4防鬆螺帽 x 1

700NZ2A

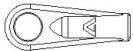

Ball link
連桿頭 x 12

700NZ2



Linkage rod(D)
連桿(D) φ1.96x42mm x 2

700NH4A

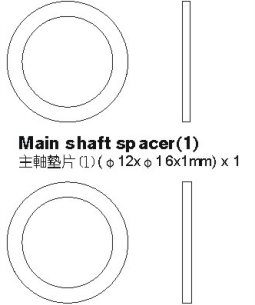

Main shaft spacer(1)
主軸墊片(1) (φ12xφ16x1mm) x 1

Spare part:
Main shaft spacer(1.2)
備品：主軸墊片(1.2)
(φ12xφ16x1.2mm) x 1

Main drive gear set
主齒輪組

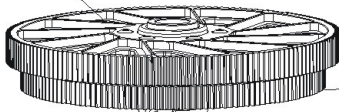

M4 Nut
M4防鬆螺帽

Socket screw
圓頭內六角軸套螺絲
M4x27mm

When tightening the main blade fixing screw, please tighten it firmly, but not over tight ten, or it may cause the damage of main blade holder and result in danger.
鎖緊主旋翼螺絲須注意適當緊度即可，過緊可能導致主旋翼夾座受損，飛行意外發生。

Socket collar screw
圓頭內六角軸套螺絲
M5x32mm

700NH1A

M5 Nut
M5防鬆螺帽

Option equipment:700 Blade
另購：700主旋翼

Linkage rod(D)
Approx 65mm x 2
連桿(D)約65mm x 2

42mm

32mm

Standard Equipment:
Main shaft spacer(1)
標準品：主軸墊片(1)
φ12xφ16x1mm

Spare part:Main shaft spacer(1.2)
備品：主軸墊片(1.2)
φ12xφ16x1.2mm

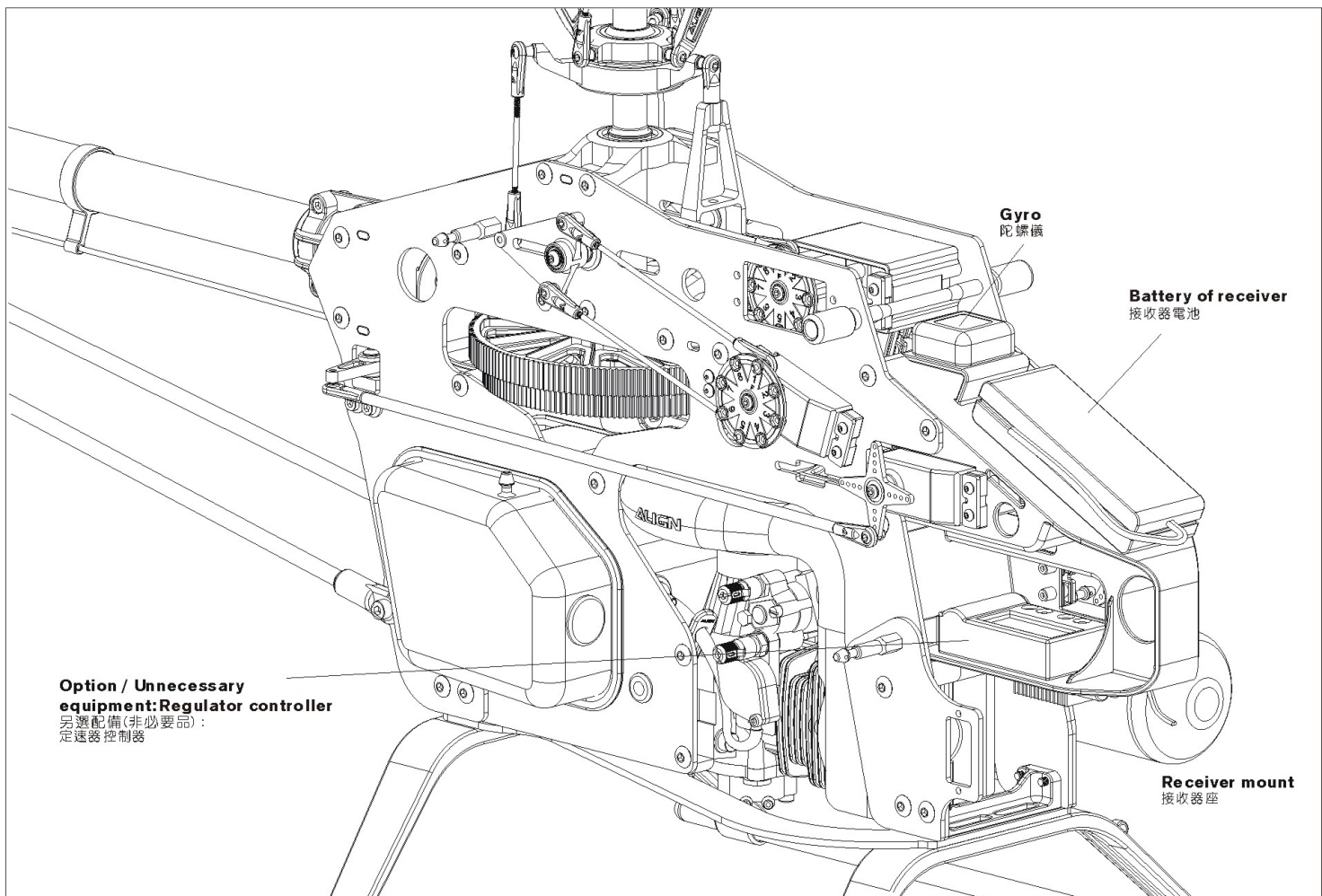
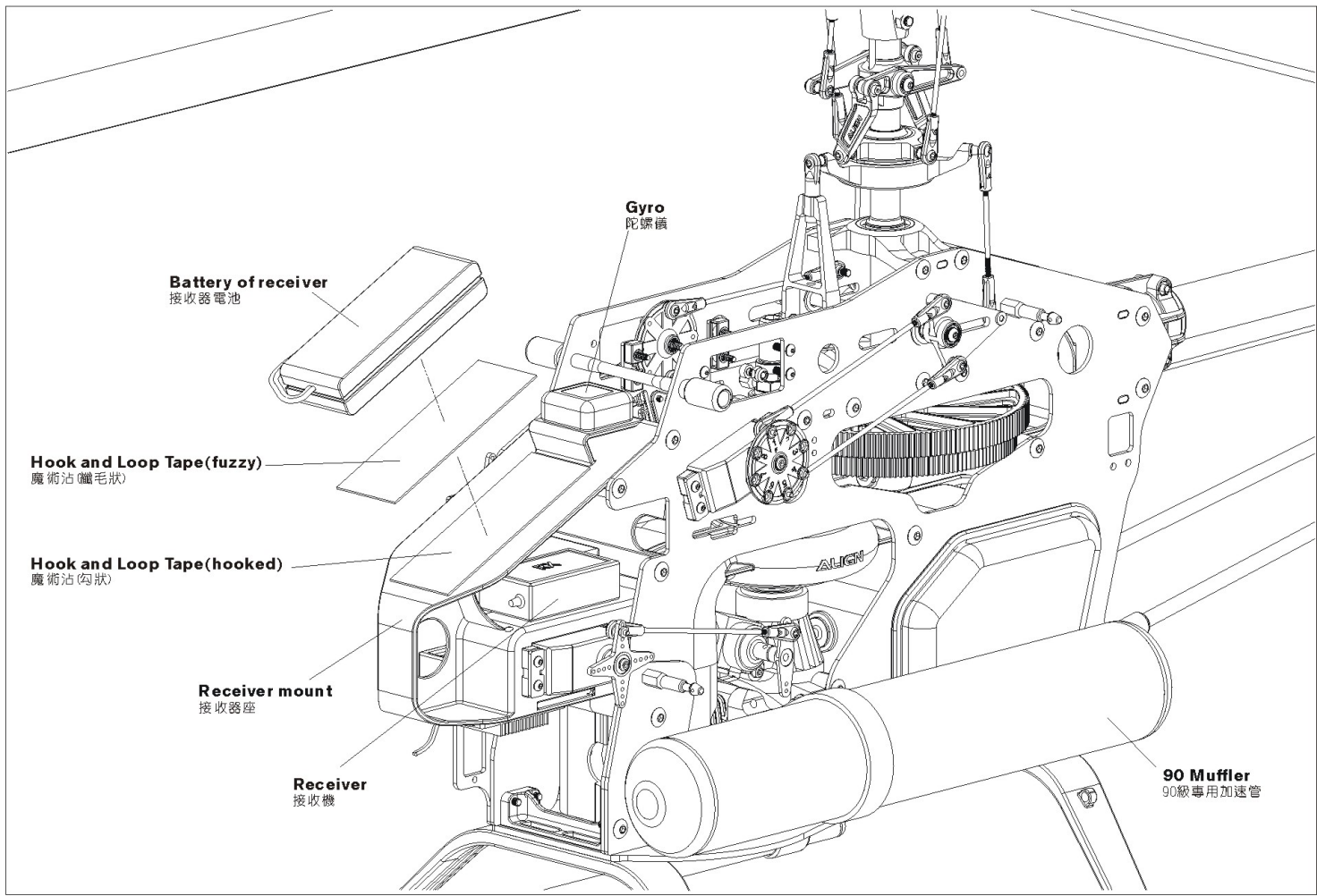

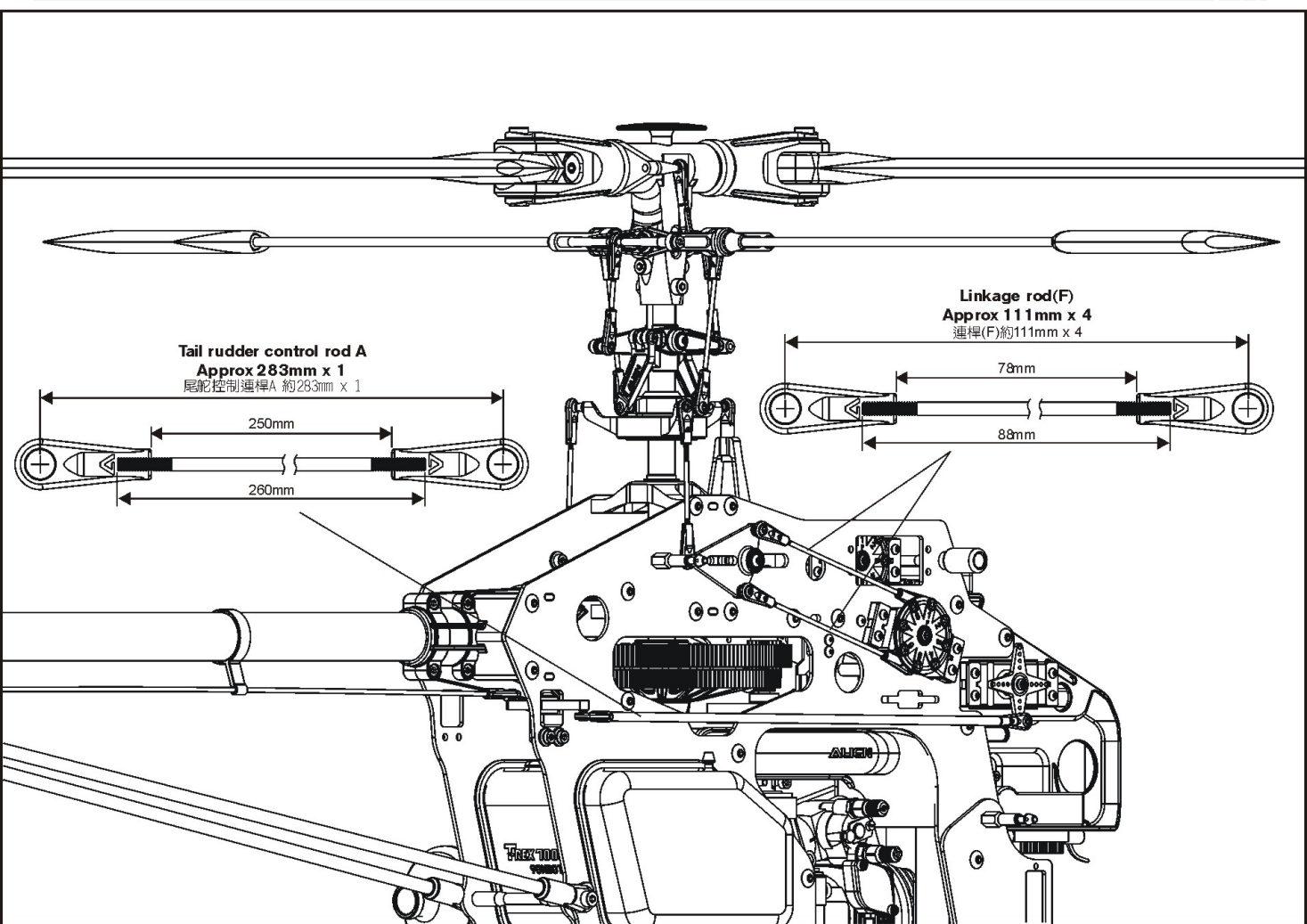

8.CANOPY ASSEMBLY 機頭罩安裝

